

TECHNICAL SPECIFICATION

UK plug type AC/DC MAINS POWER ADAPTOR 9021

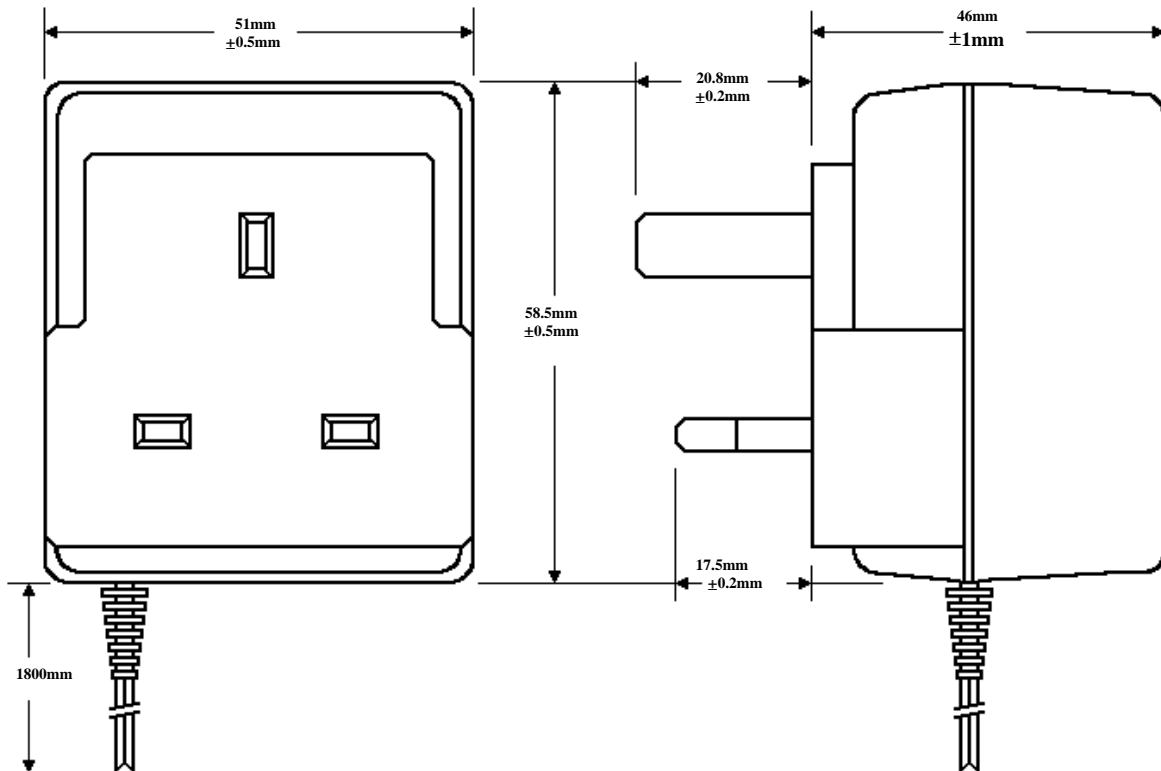

Please note : All dimensions are nominal and given in millimetres.

ELECTRICAL AND MECHANICAL CHARACTERISTICS

Input:	240vac 50/60Hz
Output:	9021 12vdc @ 300mA Unregulated
Insulation Class:	E (120 °C)
Proof Voltage:	4000v RMS (Input to Output)
Standards:	Approved To EN60950 and CE Marked
Construction:	The case is moulded in high impact plastic with partially sleeved live pins.